

CHAPTER 26 EXERCISES

1. Concrete Columns

Open the CE22EX2 drawing from the Chapter 22 Exercises. Add a concrete *Hatch* pattern to the interior of the columns as shown in Figure CE26-1. You will need to adjust the *Scale* of the *Hatch* to an appropriate size. *SaveAs* CE26EX1.

Figure CE26-1

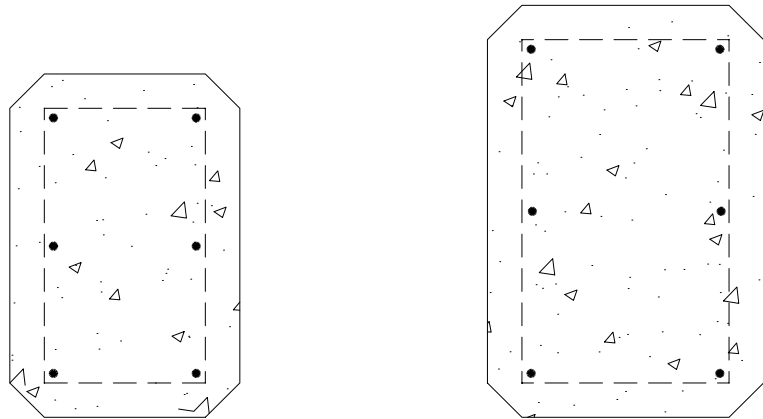

2. Septic Tank

Open the CE19EX2 drawing from the Chapter 19 Exercises. Add *Hatching* to the building, earth, concrete, and sludge as shown in Figure CE26-2. You will have to draw some temporary boundary *Plines* and then *Erase* them to create the small, irregularly shaped hatch pieces. *SaveAs* CE26EX2.

Figure CE26-2

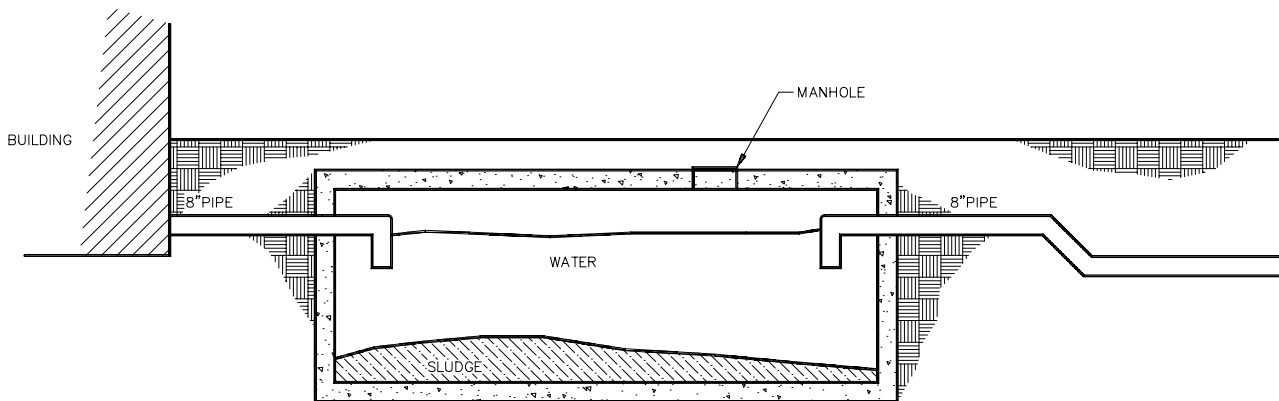

3. Framing Section

Open the FRAMING drawing from the Chapter 21 Exercises. Offset the finish floor line 6" to create a concrete slab on the interior of the building. Add Hatch patterns to represent the concrete and earth as shown in Figure CE26-3. Plot the drawing and check the scale of the Hatch patterns you have used to ensure they are neither too dense or too sparse. Save your changes.

Figure CE26-3

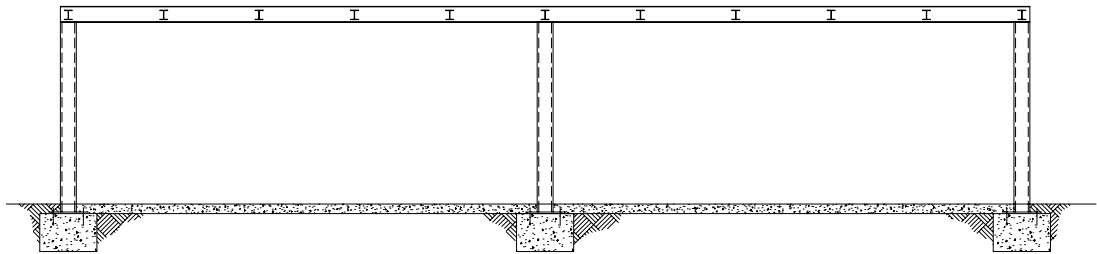

4. Retaining Wall Section

Complete the drawing of the retaining wall shown in Figure CE26-4. Omit all notes and dimensions. Include Hatch patterns as indicated. SaveAs RETWALL.

Figure CE26-4

